

binks

estate agent



Jasmine Cottage, 3 Bury Farm, Amersham, HP7 0SJ

Guide Price: £625,000

Jasmine Cottage, 3 Bury Farm, Amersham, HP7 0SJ

Character single storey barn conversion in a select courtyard development in Old Amersham close to local amenities. Attractive living room with vaulted ceiling and log-burner, re-fitted kitchen/breakfast room, Two double bedrooms, en-suite and family bathroom. Gardens to the front and two allocated parking spaces. Offered to the market with no upper chain.

Accommodation & Amenities

- Barn Conversion
- Old Amersham location
- Entrance hall
- Two double bedrooms
- En-suite and family bathroom
- Living room with vaulted ceiling
- Re-fitted Kitchen/Breakfast room
- Gardens and two allocated parking spaces
- Chain Free
- EPC: D

Bury Farm, Old Amersham, Buckinghamshire, HP7 0SJ

Approx. Gross Internal Area
70 sq m – 756 sq ft

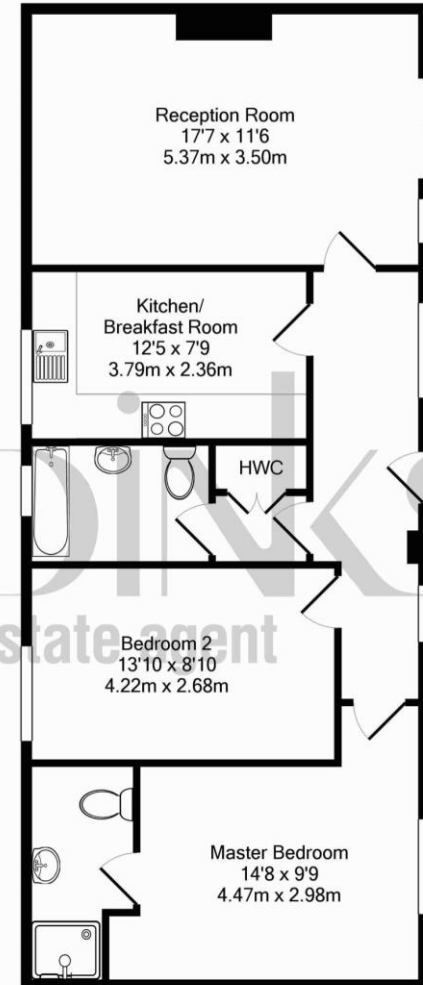

Whilst every attempt has been made to ensure the accuracy of the floor plans contained here, measurements of doors, windows and rooms are approximate and no responsibility is taken for any error, omission or mis-statement. These plans are for representation purposes only as defined by the RICS Code of Measuring Practice and should be used as such by any prospective purchaser or tenant. The services, systems and appliances listed in this specification have not been tested by Binks (Sales & Lettings) Ltd and no guarantee as to their operating ability or their efficiency can be given.



